

# Palladio Homes

LOT 305 Chisolm Way, Pimpama  
House size – 190 m<sup>2</sup>  
Lot size – 360 m<sup>2</sup>

**\$ 477,228**  
House & Land



3 Bed, 2 Bath, Kitchen/Dining/Family Room, Study & Double Garage

## Inclusions

- Fixed price site costs up to H1 soil
- Colourbond Roof
- Remote control double garage door
- Metro façade as illustrated
- Exposed aggregate driveway and porch (50m<sup>2</sup>)
- European 900mm Freestanding Upright Cooker
- European 900mm Rangehood
- Overhead kitchen cupboards
- Freestanding Dishwasher
- Soft-close Kitchen Cabinets
- Stone benchtops to Kitchen/Ensuite/Bathroom
- Daiken 12.5 Kw Fully Ducted reverse cycle A/C
- Ceiling Height 2590mm
- Flyscreens to all windows
- Ceiling fans to all bedrooms and Alfresco
- Ceramic tile flooring to main floor
- Carpet to all bedrooms and Media room
- Tiles to Alfresco
- Block out roller blinds to all windows

Contact: **Brian Orpin**  
0452 220 591  
[borpin@palladio.com.au](mailto:borpin@palladio.com.au)

Experience the **Palladio** difference

Come and visit our displays at  
25 Swan Rd, Pimpama

# The Serenity

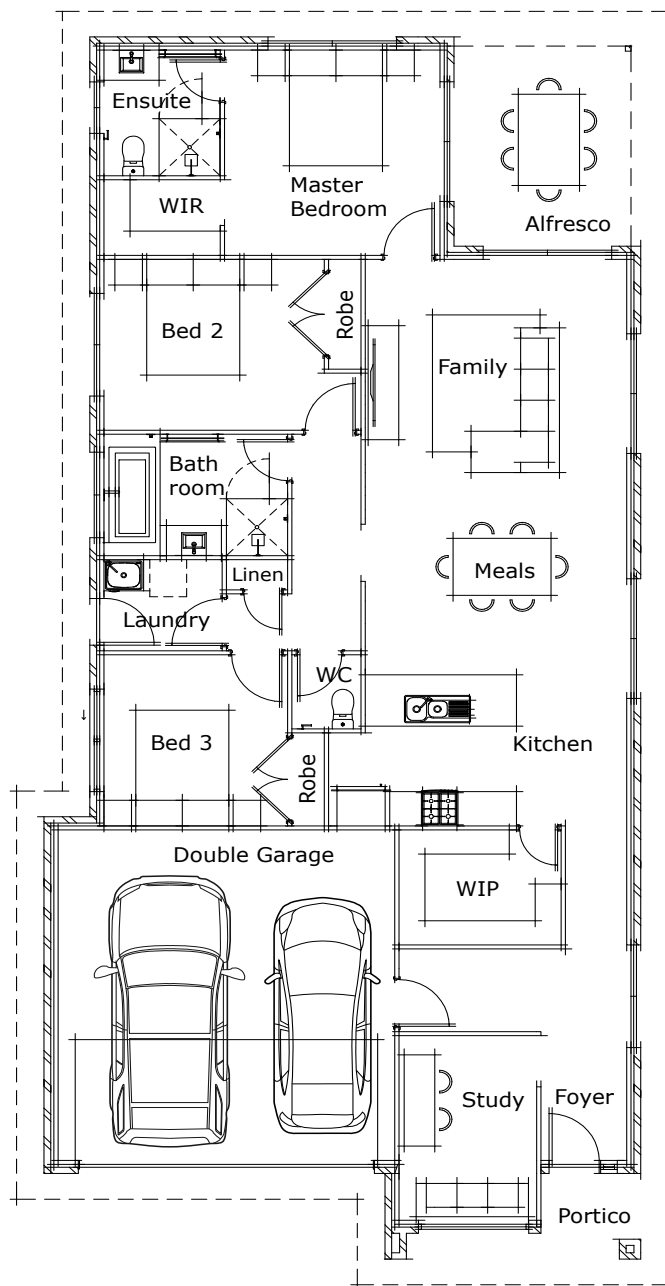

✓ Quality Comes Standard

# Palladio Homes